

N7/

Rev.No	Revision note	Date	Signature	Checked

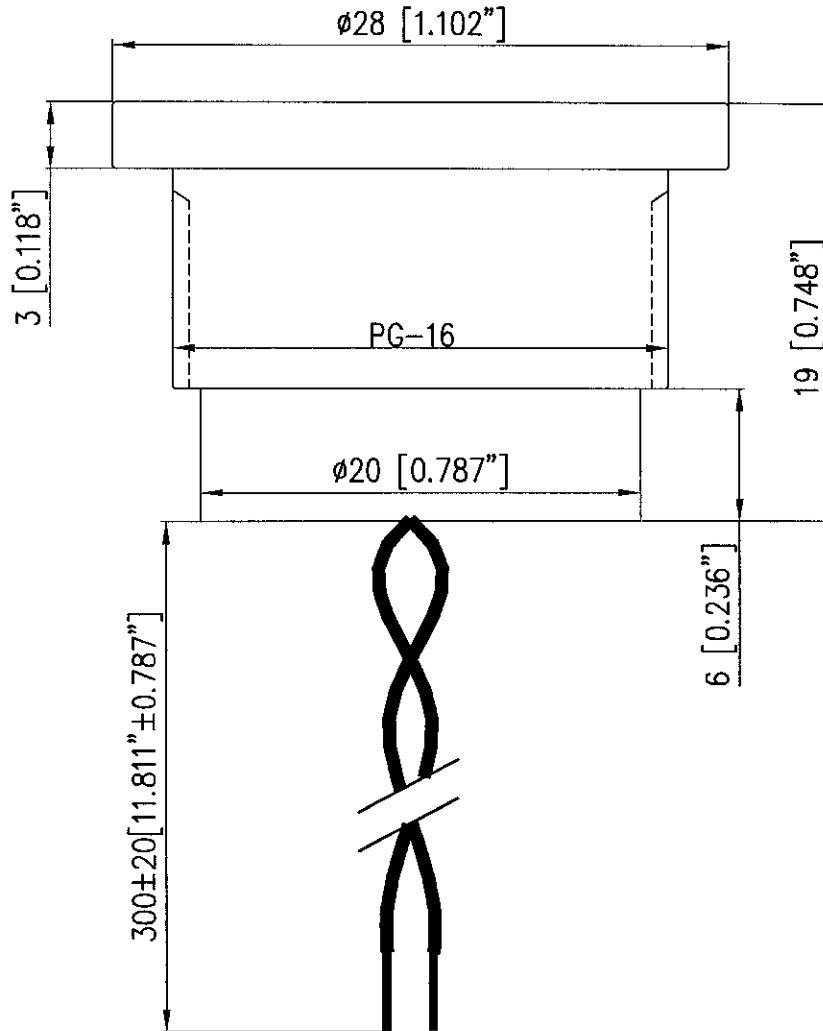

1. SPECIFICATIONS:

STAINLESS STEEL  
 CONNECTION: PVC WIRES 24 AWG  
 SWITCHING VOLTAGE: 1 - 24V AC/DC  
 SWITCHING CURRENT: 0.200 A  
 SWITCH RESISTANCE "ON": <20 OHMS  
 SWITCH RESISTANCE "OFF": >5 MOHMS  
 ACTUATION FORCE: 3-5 N  
 MAKE IMPULSE TIME: 125-300 mSEC  
 OPERATING AND STORAGE TEMP: -40°C TO +125°C

WIRING

RED } 1-24V AC/DC  
 RED } 0.2A SWITCH

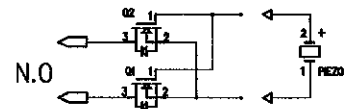

2. FINISH:

STAINLESS STEEL  
 COLOR: NATURAL

Itemref	Quantity	Title/Name, designation, material, dimension etc	Article No./Reference
Designed by Moshe Tal	Checked by Armand	Approved by date <i>[Signature]</i> 20.1.2	Filename 10402600_605-560
		Baran House 8 Omarim St. Omer industrial area 84965 Israel Tel. 972-8-6200020 Fax. 972-8-6200021	Drawing_n 605-560 Scale 3:1 Draw Date 20/3/03
		SMA1AAW2N	Cat num: 10402600 Edition 1 Sheet 1/1