

IP68

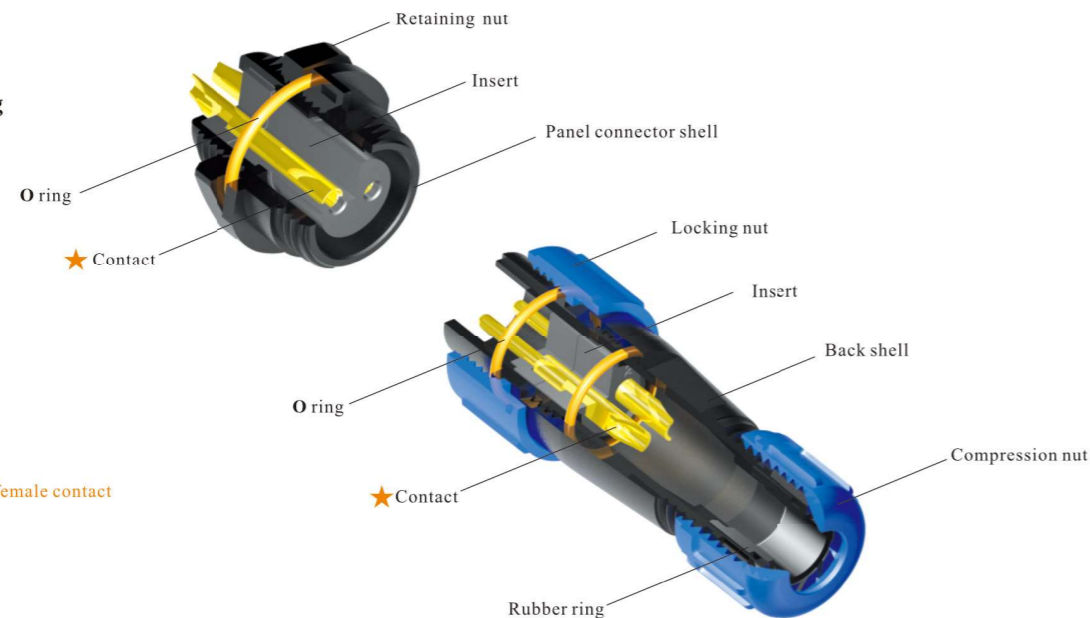

● SP Series IP68

● Threaded coupling



★ Each side can be male or female contact

Material and spec

Coupling	Threaded
Shell material	PC, Nylon66, fire resistance: V-0
Insert material	PPS, max temperature 260 °C
Contact material	Brass with gold plating
Termination	Solder: SP13, SP17, SP21, SP29 Crimp: SP17, SP21, SP29 Screw: SP21, SP29 (ø2.5, ø3, ø3.5mm contact)
Cable outer diameter range	SP11: 4-6.5 SP13 I: 4-6.5mm, II: 5-8mm SP17: 6-10mm SP21: I: 4.5-7mm, II: 7-12mm SP29: 13-16mm
IP rating	IP68
Mating cycle	500
Temperature range	-40°C ~ +85°C
Insulation resistance	2000 MΩ

SP17 Series



Cable connector
Mate with SP1711, SP1712

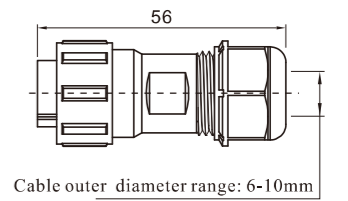
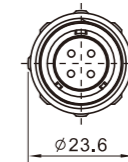

SP1710 / P --- N SP1710 / S --- N
Male contact Female contact

1: solder, 3: crimp
Number of contact



In-line cable connector
Mate with SP1710

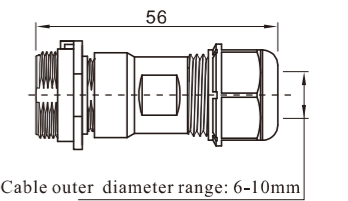
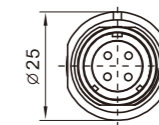

SP1711 / P --- SP1711 / S ---

Number of contact C: with cap
N: without cap
1: solder, 3: crimp



Rear-nut mount
Mate with SP1710

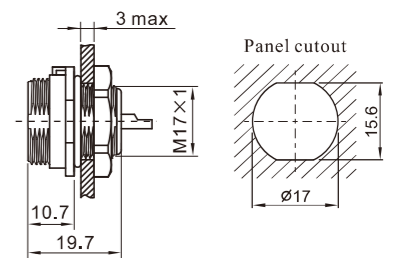
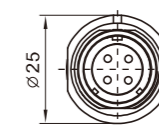

SP1712 / P --- SP1712 / S ---

Number of contact C: with cap
N: without cap
1: solder, 3: crimp

Solder contact spec

★ Crimp contact spec see P107-P110

Number of contact	2	3	4	2B	3B	4B	5	7	9	10
Male contact face view										
Rated current (A)	10	10	5	15	15	15	5	5	5	5
Contact diameter(mm)	ø1.5X2	ø1.5X3	ø1X4	ø2X2	ø2X3	ø2X4	ø1X5	ø1X7	ø1X9	ø1X10
Rated voltage (AC.V)	500	500	500	500	500	500	500	400	400	400
Test voltage(AC.V) 1 min	1500	1500	1500	1500	1500	1500	1500	1200	1200	1200
Contact resistance (mΩ)	2.5	2.5	5	2.5	2.5	2.5	5	5	5	5
Wire size (mm²/AWG)	≤2/14	≤2/14	≤0.75/18	≤2/14	≤2/14	≤2/14	≤0.75/18	≤0.75/18	≤0.75/18	≤0.75/18