

IP67

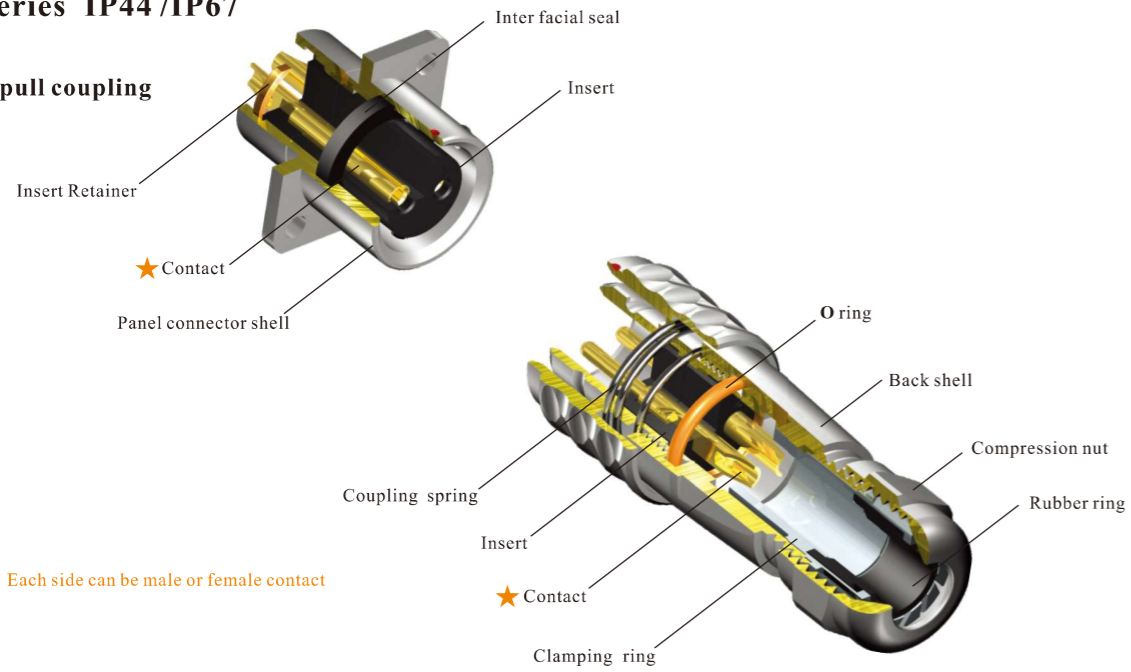

● SF Series IP44 /IP67

● Push-pull coupling



★ Each side can be male or female contact

Material and spec

Coupling	Push-pull
Shell material	Brass with chrome plating
Insert material	PPS max temperature 260 °C
Contact material	Brass with gold plating
Termination	Solder: SF6, SF8, SF10, SF12, SF16, SF20 Crimp: SF16, SF20 Screw: SF20 (Ø2.5mm contact)
Cable outer diameter range	SF6: 3-4mm SF8: 4-5mm SF10: 4-6.5mm SF12: I: 4-6.5mm, II: 5-8mm SF16 I: 5-8mm, II: 8-12mm SF20 I: 8-12mm
IP rating	SF6, SF8: IP44 / IP67 SF6B, SF8B, SF10, SF12, SF16, SF20: IP67
Mating cycle	500
Temperature range	-40°C ~ +85°C
Insulation resistance	2000MΩ

SF6 Series IP44



SF610/P

SF610/S

Male contact

Cable connector
Mate with SF611, SF612, SF615,

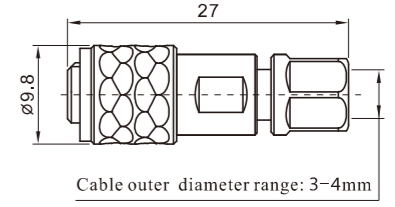
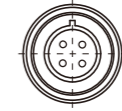

Cable outer diameter range: 3-4mm

Number of contact
Female contact



SF611/P

SF611/S

In-line cable connector
Mate with SF610

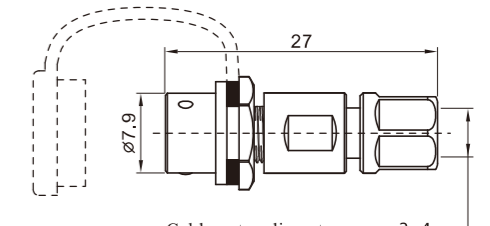

Cable outer diameter range: 3-4mm



SF612/P

SF612/S

Rear-nut mount
Mate with SF610

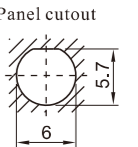
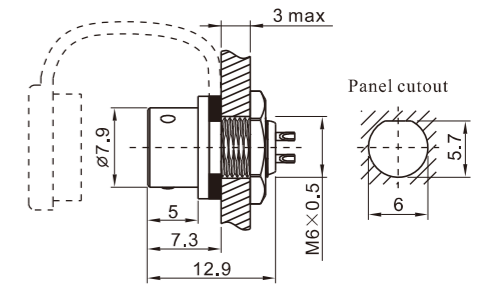
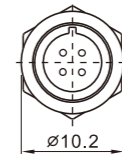

SF615/P

SF615/S

Front-nut mount
Mate with SF610

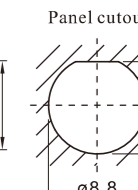
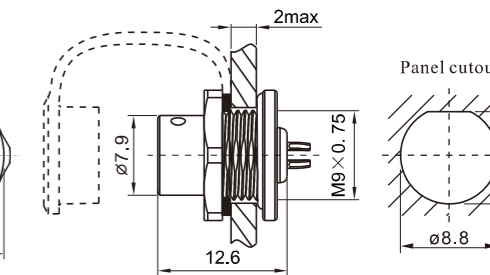
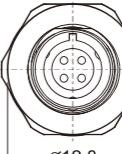

Solder contact spec

Number of contact	2	3	4	5
Male contact face view				
Rated current (A)	3	3	3	3
Contact diameter(mm)	Ø0.6×2	Ø0.6×3	Ø0.6×4	Ø0.6×5
Rated voltage (AC.V)	30	30	30	30
Test voltage(AC.V) 1 min	500	500	500	500
Contact resistance(mΩ)	10	10	10	10
Wire size(mm²/AWG)	≤0.5/20	≤0.5/20	≤0.5/20	≤0.5/20

SF6B Series IP67



Cable connector
Mate with SF611B, SF612B,
SF615B

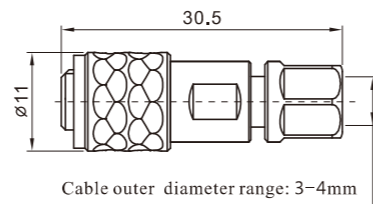
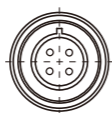

SF610B/P

SF610B/S

Male contact

Number of contact
Female contact



In-line cable connector
Mate with SF610B

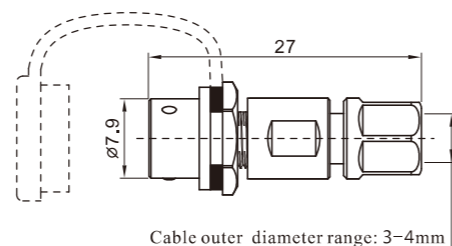
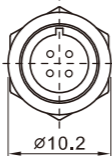

SF611B/P

SF611B/S



Rear-nut mount
Mate with SF610B

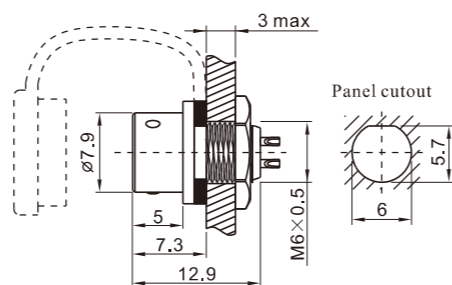
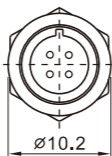

SF612B/P

SF612B/S



Front-nut mount
Mate with SF610B

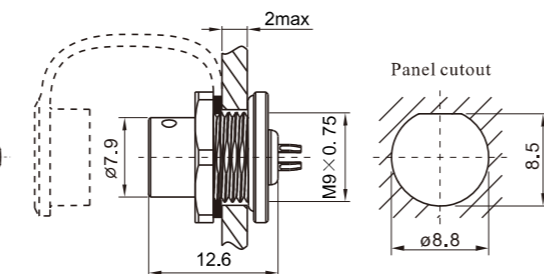
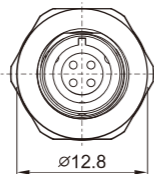

SF615B/P

SF615B/S

Solder contact spec

Number of contact	2	3	4	5
Male contact face view				
Rated current (A)	3	3	3	3
Contact diameter(mm)	ø0.6×2	ø0.6×3	ø0.6×4	ø0.6×5
Rated voltage (AC.V)	30	30	30	30
Test voltage(AC.V) 1 min	500	500	500	500
Contact resistance(mΩ)	10	10	10	10
Wire size (mm ² /AWG)	≤0.5/20	≤0.5/20	≤0.5/20	≤0.5/20