

SF20 Series IP67

SF
20

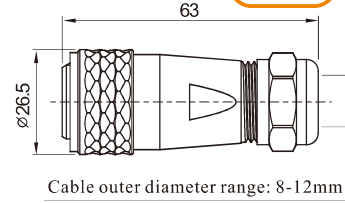

Cable connector
Mate with SF2011, SF2012,
SF2013, SF2015

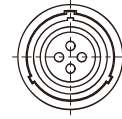

SF2010 / P --- SF2010 / S ---

Male contact
1: solder, 2: screw, 3: crimp
Number of contact
Female contact



In-line cable connector
Mate with SF2010

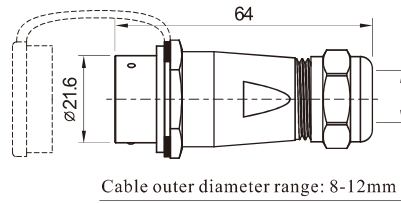

SF2011 / P --- SF2011 / S ---



Rear-nut mount
Mate with SF2010

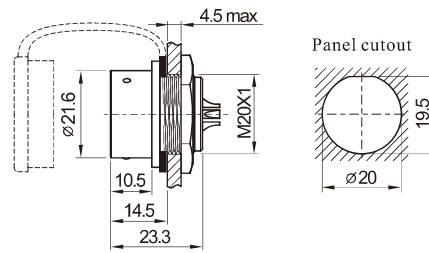

4.5 max

Panel cutout

SF2012 / P --- SF2012 / S ---

1: solder, 2: screw, 3: crimp
Number of contact



Square flange
Mate with SF2010

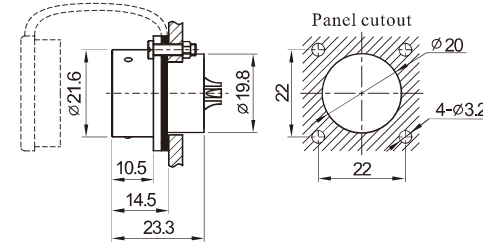
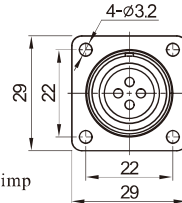

4-ø3.2

Panel cutout

SF2013 / P --- SF2013 / S ---

1: solder, 2: screw, 3: crimp
Number of contact



Front-nut mount
Mate with SF2010

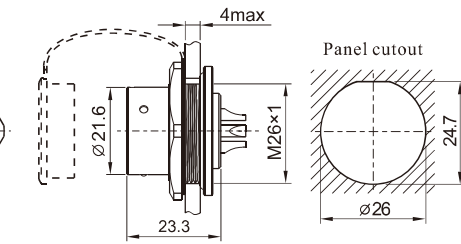

4 max

Panel cutout

SF2015 / P --- SF2015 / S ---

1: solder, 2: screw, 3: crimp
Number of contact

Solder contact spec

★ Crimp contact spec see P107-P110 ★ Screw contact spec see P111-P112

Number of contact	2	3	4	5	6	6B	7	8	9	12	15
Male contact face view											
Rated current (A)	25	25	25	10	25	30	10	10	5	5	5
Contact diameter(mm)	ø2.5X2	ø2.5X3	ø2.5X4	ø1.5X5	ø2.5X4 ø1X2	ø3X2 ø1X4	ø1.5X7	ø1.5X8	ø1X9	ø1X12	ø1X15
Rated voltage (AC.V)	500	500	500	500	500	500	500	500	400	400	400
Test voltage(AC.V) 1 min	1500	1500	1500	1500	1500	1500	1500	1500	1200	1200	1200
Contact resistance (mΩ)	1	1	1	2.5	1	1	2.5	2.5	5	5	5
Termination	solder / screw	solder / screw	solder / screw	solder	solder	solder	solder	solder	solder	solder	solder
Wire size for solder (mm / AWG)	≤4/11	≤4/11	≤4/11	≤2/14	≤4/11 ≤0.75/18	≤4/11 ≤0.75/18	≤2/14	≤2/14	≤0.75/18	≤0.75/18	≤0.75/18
Wire size for screw termination (mm ² / AWG)	≤1.5/15	≤1.5/15	≤1.5/15	/	/	/	/	/	/	/	/



SF Series IP44 / IP67

Push-pull coupling

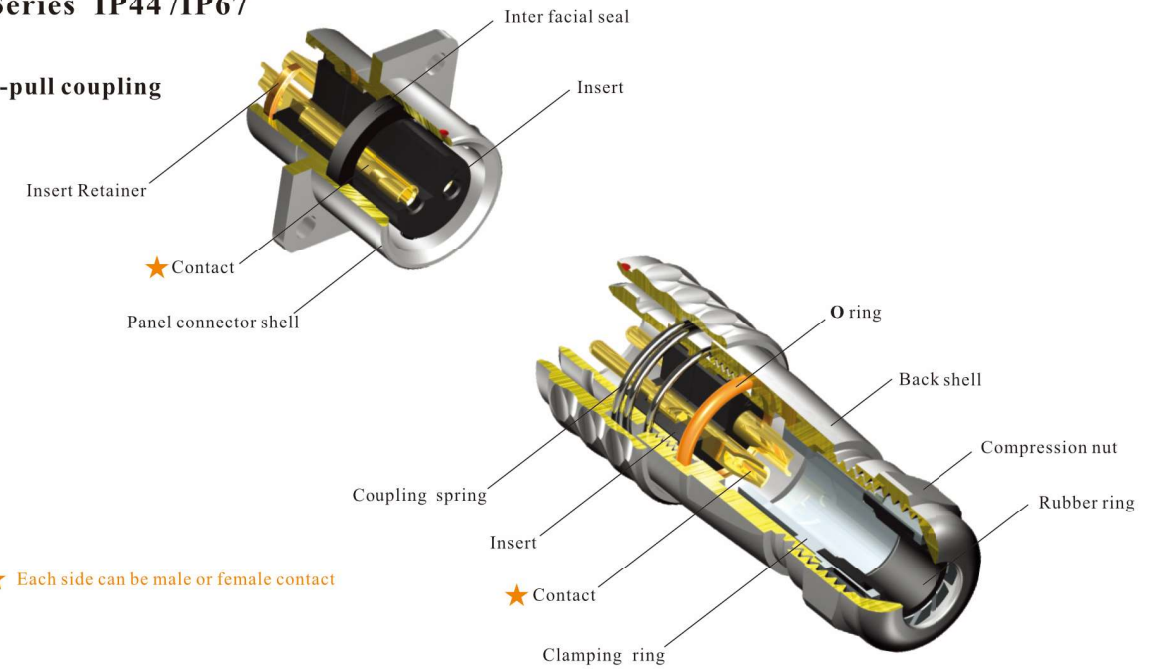

★ Each side can be male or female contact

Material and spec

Coupling	Push-pull
Shell material	Brass with chrome plating
Insert material	PPS max temperature 260 °C
Contact material	Brass with gold plating
Termination	Solder: SF6, SF8, SF10, SF12, SF16, SF20 Crimp: SF16, SF20 Screw: SF20 (ø2.5mm contact)
Cable outer diameter range	SF6: 3-4mm SF8: 4-5mm SF10: 4-6.5mm SF12: I: 4-6.5mm, II: 5-8mm SF16 I: 5-8mm, II: 8-12mm SF20 I: 8-12mm
IP rating	SF6, SF8: IP44 / IP67 SF6B, SF8B, SF10, SF12, SF16, SF20: IP67
Mating cycle	500
Temperature range	-40°C ~ +85°C
Insulation resistance	2000MΩ