

## SA20 Series

**SA  
20**



Cable connector  
Mate with SA2011, SA2012, SA2013, SA2015

SA2010/P --- SA2010/S  
Male contact  
Female contact  
Number of contact

1: solder, 2: screw, 3: crimp  
Colour:  
B: Black  
S: Silver  
L: Blue (special order)  
G: Green (special order)  
R: Red (special order)

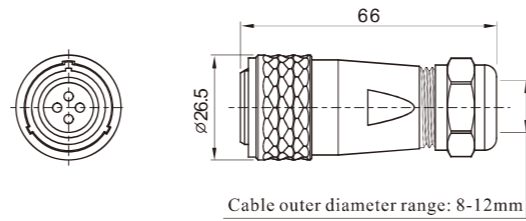

In-line cable connector  
Mate with SF2010

SA2011/P --- SA2011/S

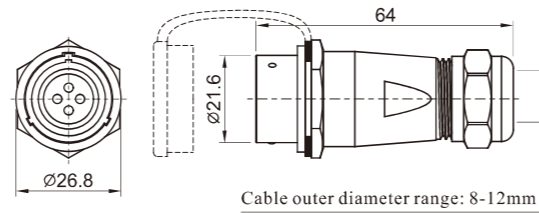

Rear-nut mount  
Mate with SA2010

SA2012/P --- SA2012/S

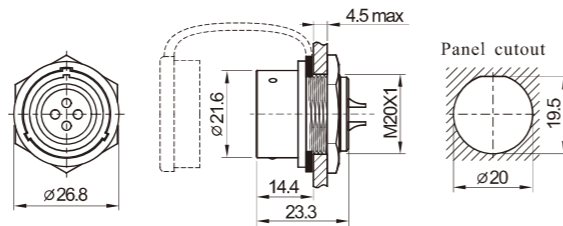

Square flange  
Mate with SA2010

SA2013/P --- SA2013/S

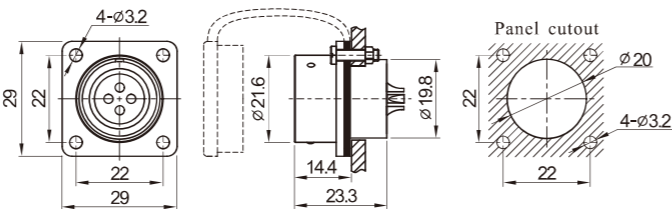

Front-nut mount  
Mate with SA2010

SA2015/P --- SA2015/S

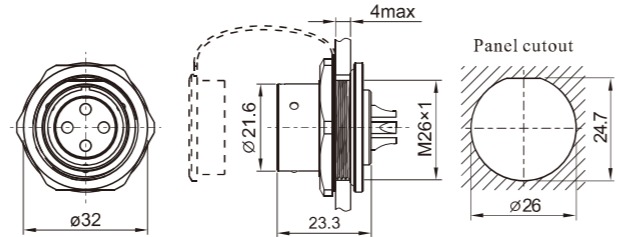

### Solder contact spec

★ Crimp contact spec see P107-P110 ★ Screw contact spec see P111-P112

Number of contact	2	3	4	5	6	6B	7	8	9	12	15
Male contact face view											
Rated current (A)	25	25	25	10	25	30	10	10	5	5	5
Contact diameter(mm)	2.5X2	2.5X3	2.5X4	1.5X5	2.5X4 1X2	3X2 1X4	1.5X7	1.5X8	1X9	1X12	1X15
Rated voltage (AC.V)	500	500	500	500	500	500	500	500	400	400	400
Test voltage(AC.V) 1 min	1500	1500	1500	1500	1500	1500	1500	1500	1200	1200	1200
Contact resistance (mΩ)	1	1	1	2.5	1	1	2.5	2.5	5	5	5
Termination	solder / screw	solder / screw	solder / screw	solder	solder	solder	solder	solder	solder	solder	solder
Wire size for solder (mm <sup>2</sup> / AWG)	≤4/11	≤4/11	≤4/11	≤2/14	≤4/11 ≤0.75/18	≤4/11 ≤0.75/18	≤2/14	≤2/14	≤0.75/18	≤0.75/18	≤0.75/18
Wire size for screw termination (mm <sup>2</sup> / AWG)	≤1.5/15	≤1.5/15	≤1.5/15	/	/	/	/	/	/	/	/



### SA Series IP67

### Push-pull coupling

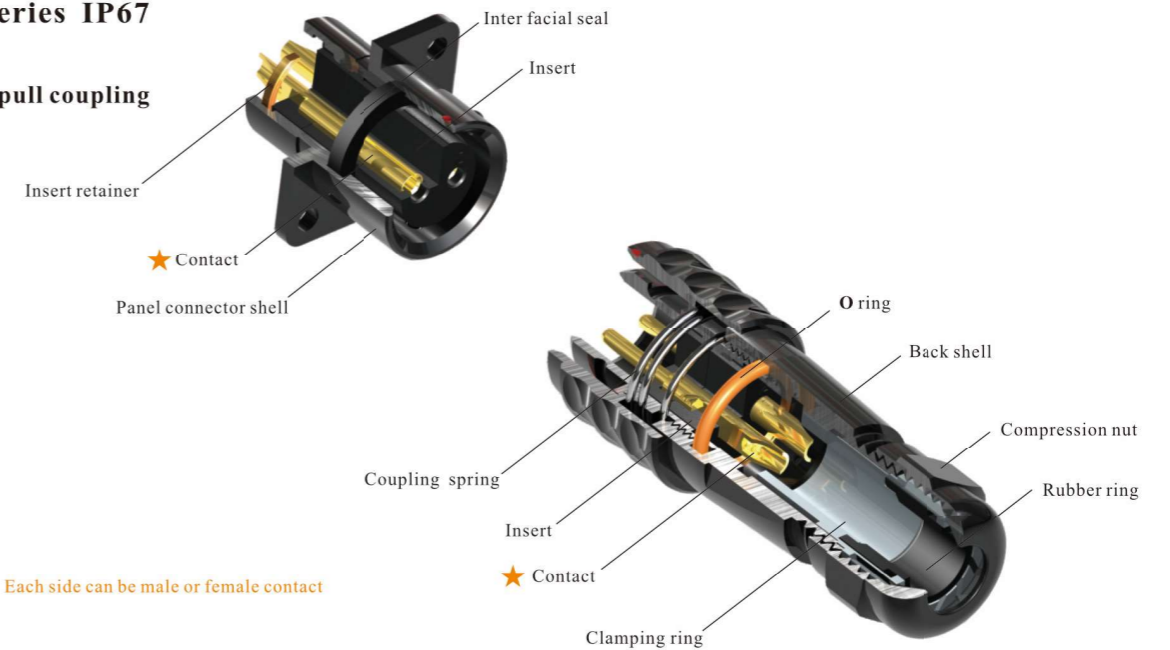

★ Each side can be male or female contact

### Material and spec

Coupling	Push-pull
Shell material	Anodized aluminium
Insert material	PPS, max temperature 260 °C
Contact material	Brass with gold plating
Termination	Solder: SA6, SA8, SA10, SA12, SA16, SA20, SA28 Crimp: SA16, SA20, SA28 Screw: SA20, SA28
Cable outer diameter range	SA6: 3.5-4mm SA8: 4-5mm SA10: 4-6.5mm SA12: I: 4-6.5mm, II: 5-8mm SA16: I: 5-8mm, II: 8-12mm SA20: 8-12mm SA28: 13-16mm
IP rating	IP67
Mating cycle	500
Temperature range	-40°C ~ +85°C
Insulation resistance	2000 MΩ