



● M23 for power

Material and spec

Shell material	Zinc alloy with nickel plating
Contact material	Brass with gold plating
Insert material	PA66
Insulation resistance	>10 ¹³ mΩ
Termination	Crimp
Temperature range	-40°C ~ +125°C
Mating cycle	1000
Cable outer diameter range	I: 4-8mm (Special order) II: 8-13mm (Standard) III: 12-17mm (Special order)
IP rating	IP67
Coupling	Threaded coupling



Male contact cable connector

M23DJ_TK
Number of contact

- Colour
Gray:GY (Standard)
Black:BK (Special order),Orange:OG (Special order)
Blue:BU (Special order),Green:GN (Special order)
Purple:PL (Special order)
- Cable outer diameter range
I: 4-8mm (Special order) II: 8-13mm (Standard)
III: 12-17mm (Special order)
- S: Shield
U: Unshielded

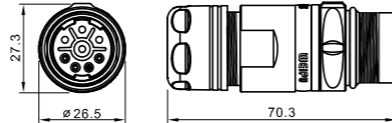

Female contact cable connector

M23DK_TK_

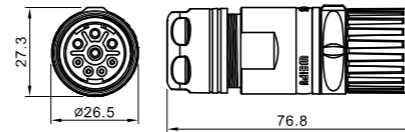

Male contact square flange receptacle

M23DJ_Z_

Number of contact

- Colour
Gray:GY (Standard)
Black:BK (Special order),Orange:OG (Special order)
Blue:BU (Special order),Green:GN (Special order)
Purple:PL (Special order)

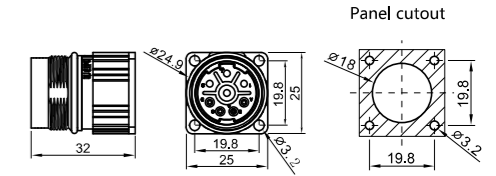

Female contact square flange receptacle

M23DK_Z_

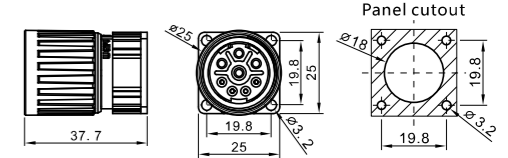

Male contact angled cable connector

M23DJ_TL_

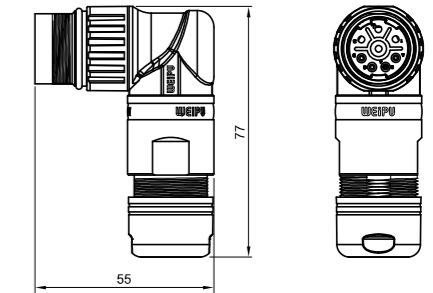

Female contact angled cable connector

M23DK_TL_

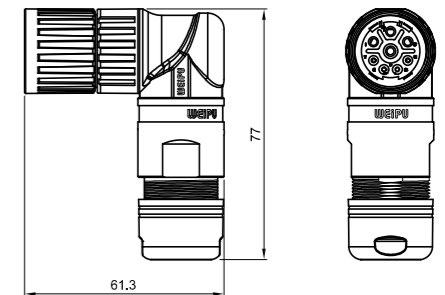

Male contact angled square flange receptacle

M23DJ_ZL_

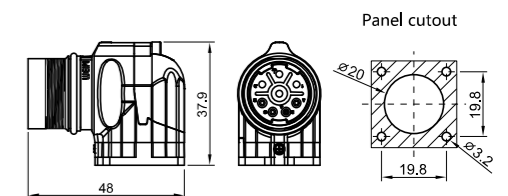

Female contact angled square flange receptacle

M23DK_ZL_

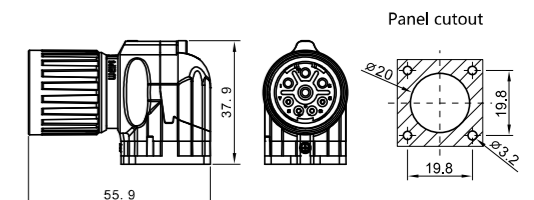

M23 for power contact arrangement and spec

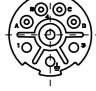
Male contact face view	Number of contact	Contact diameter (mm)	Rated voltage (AC.V)	Rated current (A)	Test voltage (AC.V)Imin
	6(5+PE)	∅2	600	28	4000
	8(3+4+PE)	∅1×4 ∅2×4	300 600	8 28	2500

M23 contact spec

8A Crimp contact

Contact diameter:∅1

Material: Brass with gold plating

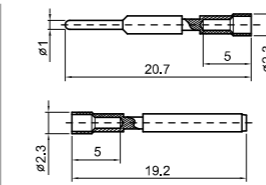

8A Male crimp contact

Wire size	Stripping length	Male crimp contact p/n	Crimping tool p/n
0.25-1.0mm ² AWG 23-17	4mm	YJ1-20.7-1.0AU	CT-W26/12

8A Female crimp contact

Wire size	Stripping length	Female crimp contact p/n	Crimping tool p/n
0.25-1.0mm ² AWG 23-17	4mm	YK1-19.2-1.0AU	CT-W26/12

28A Crimp contact

Contact diameter:∅2

Material: Brass with gold plating

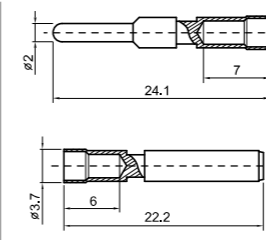

28A Male crimp contact

Wire size	Stripping length	Male crimp contact p/n	Crimping tool p/n
1-2.5mm ² AWG 18-13	7mm	YJ2-24.1-2.5AU	CT-W26/12
2.5-4mm ² AWG 13-12	7mm	YJ2-24.1-4.0AU	CT-W26/12

28A Female crimp contact

Wire size	Stripping length	Female crimp contact p/n	Crimping tool p/n
1-2.5mm ² AWG 18-13	6mm	YK2-22.2-2.5AU	CT-W26/12
2.5-4mm ² AWG 13-12	6mm	YK2-22.2-4.0AU	CT-W26/12

Crimping tool

For crimping the male / female contacts



Part number	Crimping wire range
CT-P20/28	0.08-0.52mm ² AWG 28-20
CTW-0.14/4	0.14-4mm ² AWG 25-11
CT-4/10	4-10mm ² AWG 11-7