

Push Lock Series



Push Lock S2 (2A, 4A) Series
Push Lock S3 (10A) Series



Product

Push Lock S2 Panel

1.
S2 Panel Rear Mount Male//Female Solder Part No. GT26120 Series 118
2.
S2 Panel Square Rear Mount Male//Female Solder Part No. GT2612A Series 118

Push Lock S3 Panel

1.
S3 Panel Rear Mount Male//Female Solder Part No. GT26130 Series 119

Push Lock S2 Cable End

1.
S2 Field Installable Cable End Male//Female Solder Part No.GT26121 Series. 119

Push Lock S3 Cable End

1.
S3 Field Installable Cable End Male//Female Crimp Part No.GT26131 Series. 120

Cap

1. S2 Cap
S2 Metal Cap Push Lock Part No. GT2C612 Series 121
2. S3 Cap
S3 Metal Cap Push Lock Part No. GT2C613 Series 121



Material		
	S2	S3
Panel Housing // Base	Thermoplastic	
Panel Metal Body // Metal Hex Nut	Copper Alloy	
Panel Metal Ball	SUS	
Panel Contacts	Copper Alloy, Au Plating	
Panel O-Ring // Gasket	Silicone	
Glue	Epoxy	

Technical Data		
Insulation Resistance	DC500V±10%, test for 1 minute and the insulation resistance should be more than 100MΩ	
Dielectric Withstanding Voltage	5 Ways: 1000 VAC between contacts , 1000 VAC between contacts and metal-housing, for 1±5s min.	1500 V AC contact-to-contact, for 1min.
Contact Resistance	10mΩ at 10mA Max	
Durability	2000 cycles insertion/extraction cycles at a maximum rate of 200cycles per hour.	
Thermal Shock	5 cycles at -40°C / +105°C , after the test, the function and appearance can't be impacted.	
Waterproof Test	Submersion in water 1 meter for 24hours.	
Temperature Range	-40°C / +85°C	
Wire Gauge	22 AWG ~ 28 AWG	16AWG ~ 22 AWG

Push Lock S2 Panel

S2 Panel Rear Mount Female Solder

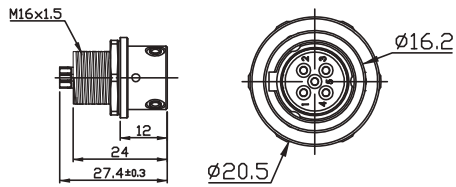

At Rear Of Panel	Cable Length	Ordering No.
Push Lock S2 4A 5P Panel Rear Mount Female Solder		GT261200-03050
Push Lock S2 2A 8P Panel Rear Mount Female Solder		GT261200-02080

S2 Panel Rear Mount Male Solder

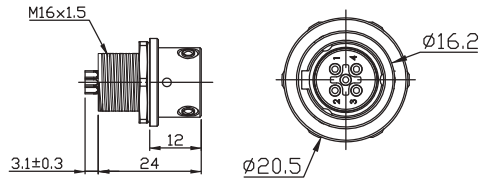

At Rear Of Panel	Cable Length	Ordering No.
Push Lock S2 4A 5P Panel Rear Mount Male Solder		GT261201-03050
Push Lock S2 2A 8P Panel Rear Mount Male Solder		GT261201-02080

S2 Panel Square Solder

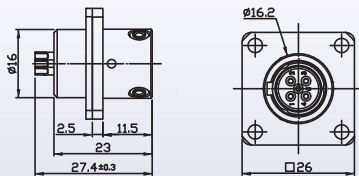

At Rear Of Panel	Cable Length	Ordering No.
Push Lock S2 4A 5P Panel Square Female Solder		GT2612A0-03050
Push Lock S2 2A 8P Panel Square Female Solder		GT2612A0-02080
Push Lock S2 4A 5P Panel Square Male Crimp		GT2612A1-03050
Push Lock S2 2A 8P Panel Square Male Crimp		GT2612A1-02080

S3 Panel Rear Mount Female Solder

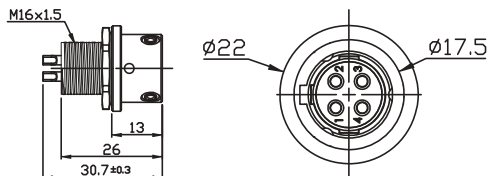

At Rear Of Panel	Cable Length	Ordering No.
Push Lock S3 10A 3P Panel Rear Mount Female Solder		GT261300-04030
Push Lock S3 10A 4P Panel Rear Mount Female Solder		GT261300-04040

S3 Panel Rear Mount Male Solder

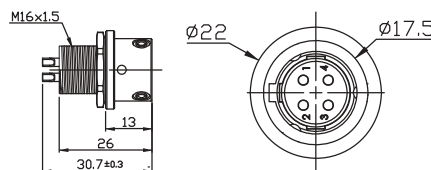

At Rear Of Panel	Cable Length	Ordering No.
Push Lock S3 10A 3P Panel Rear Mount Male Solder		GT261301-04030
Push Lock S3 10A 4P Panel Rear Mount Male Solder		GT261301-04040

Push Lock S2 Cable End

S2 Field Installable Cable End Female Crimp

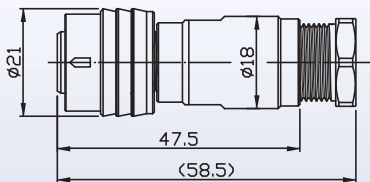

At Rear Of Cable	Cable Length	Ordering No.
Push Lock S2 4A 5P Field Installable Cable End Female Crimp	*	GT261210-13050
Push Lock S2 2A 8P Field Installable Cable End Female Crimp	*	GT261210-12080

S2 Field Installable Cable End Male Crimp

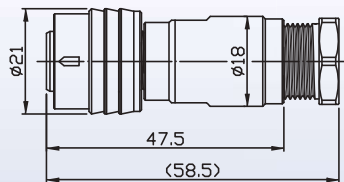

At Rear Of Cable	Cable Length	Ordering No.
Push Lock S2 4A 5P Field Installable Cable End Male Crimp	*	GT261211-13050
Push Lock S2 2A 8P Field Installable Cable End Male Crimp	*	GT261211-12080

Push Lock S3 Cable End

S3 Field Installable Cable End Female Crimp

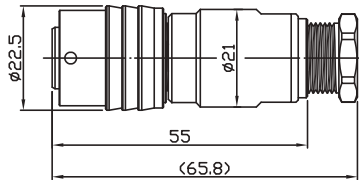

At Rear Of Cable	Cable Length	Ordering No.
Push Lock S3 10A 3P Field Installable Cable End Female Crimp	*	GT261310-14030
Push Lock S3 10A 4P Field Installable Cable End Female Crimp	*	GT261310-14040

S3 Field Installable Cable End Male Crimp

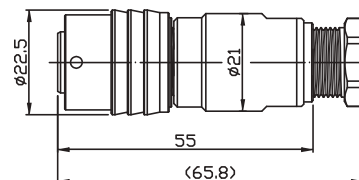

At Rear Of Cable	Cable Length	Ordering No.
Push Lock S3 10A 3P Field Installable Cable End male Crimp	*	GT261311-14030
Push Lock S3 10A 4P Field Installable Cable End male Crimp	*	GT261311-14040

S2 Metal Cap For Push Lock Panel With Metal Lanyard (M3 Screw)

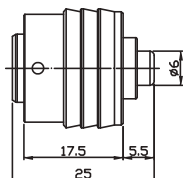

Appearance	Ordering No.
S2 Metal Cap for Push Lock Panel	GT2C612002
S2 Metal Cap For Push Lock Panel With Metal Lanyard (M3 Screw)	GT2C612062

S3 Metal Cap For Push Lock Panel With Metal Lanyard (M3 Screw)

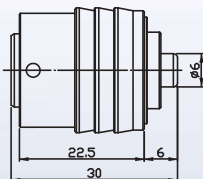

Appearance	Ordering No.
S3 Metal Cap For Push Lock Panel	GT2C613002
S3 Metal Cap For Push Lock Panel With Metal Lanyard (M3 Screw)	GT2C613062