

# GENERAL PURPOSE SWITCH GP SERIES

## General purpose switch GP Series

Heavy-duty snap-action switch with ultra-small travel differential

- Current rating up to 20 amps at 250 VAC
- Wide variety of actuators
- Screw or solder terminals available
- Mechanical life tested to over 20 million cycles
- Double throw switching function



## Technical specifications

<b>Series</b>	<b>GP ①</b>
<b>Ambient temperature</b>	0°C to +55°C max. UL -5°C to +40°C VDE
<b>Dielectric strength</b>	1,000 VAC 50/60 Hz for 1 minute
<b>Insulation resistance</b>	100 MΩ min. at 500 VDC
<b>Initial contact resistance</b>	15 mΩ max.
<b>Mounting</b>	US Holes: #6-32 Fastener with 6.0 In-Lb max. torque Metric Holes: M4 Fastener with 6.0 In-Lb max torque
<b>UL file number</b>	E184788
<b>Material specifications</b>	
<b>Case/cover</b>	Phenolic
<b>Actuator</b>	Thermoplastic nylon
<b>Contacts</b>	Silver alloy
<b>Terminals</b>	Screw terminals: brass Solder terminals: copper alloy
<b>Lever actuator</b>	Nickel plated steel

## Terminals ②

Type	Code
Solder terminals	S
Screw terminals	T

## Electrical rating and operating life ③

Type	Code	
according to EN *	according to UL	
-	20 A 250 VAC	B
15 A 250 VAC	15 A 250 VAC	C

\* Only for versions with screw terminals

## Actuator ④

Actuator types	Code, 1 <sup>st</sup> digit
Button	N
Straight lever	L
Roller	R

## Actuator implementation Code, 2<sup>nd</sup> digit

Pin button actuator	A
Button actuator	C
Overtravel button actuator	D
Impulse roller lever	G
Panelmount overtravel button actuator	H
Short hinge roller lever	M
Leaf roller level	R
Long straight lever	S

## Mounting holes ⑤

Type	Code
Metric version m4	01
US version #6-32	11

Generation of order code (example)  
The order code consists of 5 parameters:

①	②	③	④	⑤
Series	Terminals	Electrical rating	Actuator	Mounting holes
GP = General purpose switch	T = Screw terminal	B = 20 A, 250 VAC	LS = Long straight lever	01 = Metric version M4

- Not every configurable variant is available for order. Please contact us.
- The final two digits of article numbers on commercial documents refer to the index of the respective drawing.

## Terminal types

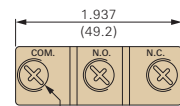
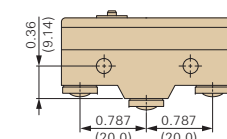

Screw terminal

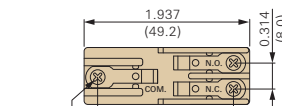
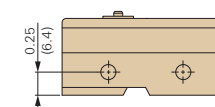

Solder terminal

## Mounting holes

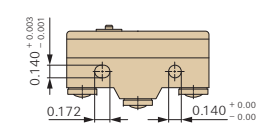

U.S. version

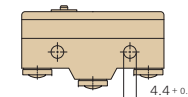

Metric version M4

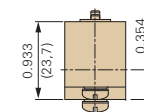
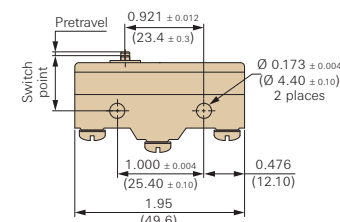

Dimensions in inch (mm)

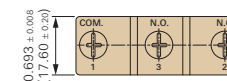

Terminal callouts may also be listed numerically.

## Commonly stocked parts

Switch	Contact arrangement	Electric rating according		Terminals	Actuator
		to EN	to UL		
GPTBLS01	Double throw	15 A 250 VAC	20 A 250 VAC	Screw terminal	Long straight lever
GPTBNA01	Double throw	15 A 250 VAC	20 A 250 VAC	Screw terminal	Pin button actuator
GPTBRM01	Double throw	15 A 250 VAC	20 A 250 VAC	Screw terminal	Short hinge roller lever
GPTCLR01	Double throw	15 A 250 VAC	15 A 250 VAC	Screw terminal	Leaf actuator
GPTCLS01	Double throw	15 A 250 VAC	15 A 250 VAC	Screw terminal	Long straight lever
GPTCLS02	Double throw	15 A 250 VAC	15 A 250 VAC	Screw terminal	Straight lever
GPTCNA01	Double throw	15 A 250 VAC	15 A 250 VAC	Screw terminal	Pin button actuator
GPTCNC01	Double throw	15 A 250 VAC	15 A 250 VAC	Screw terminal	Button actuator
GPTCND01	Double throw	15 A 250 VAC	15 A 250 VAC	Screw terminal	Overtravel button actuator
GPTCNH01	Double throw	15 A 250 VAC	15 A 250 VAC	Screw terminal	Panelmount overtravel button actuator
GPTCRG01	Double throw	15 A 250 VAC	15 A 250 VAC	Screw terminal	Impuls roller lever
GPTCRH01	Double throw	15 A 250 VAC	15 A 250 VAC	Screw terminal	Panelmount overtravel roller actuator
GPTCRH02	Double throw	15 A 250 VAC	15 A 250 VAC	Screw terminal	Panelmount overtravel cross roller actuator
GPTCRM01	Double throw	15 A 250 VAC	15 A 250 VAC	Screw terminal	Short hinge roller lever
GPTCRR01	Double throw	15 A 250 VAC	15 A 250 VAC	Screw terminal	Leaf roller lever
GPTCRS01	Double throw	15 A 250 VAC	15 A 250 VAC	Screw terminal	Long hinge roller lever